

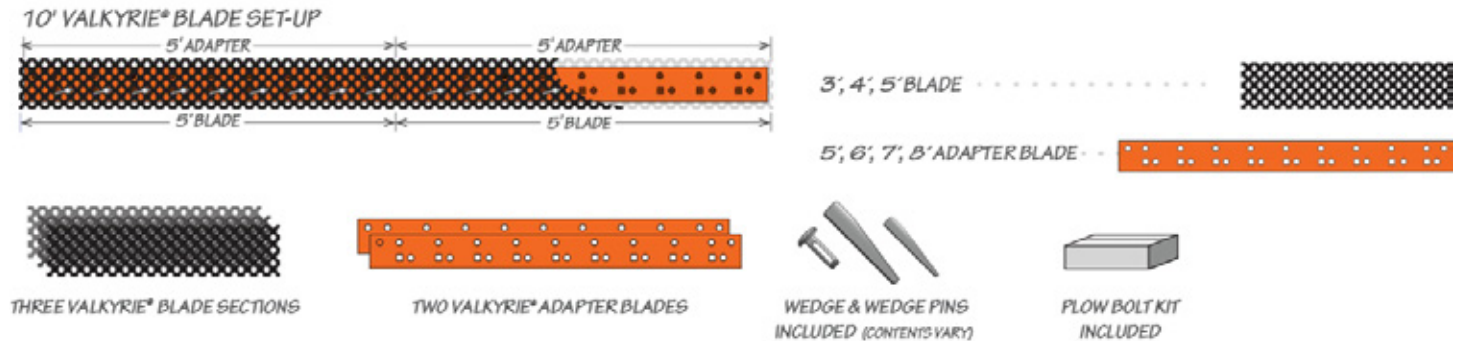

## INSTALLATION INSTRUCTIONS

# Valkyrie® Perforated Cutting Edge System

### PARTS INCLUDED



### IMPORTANT!

The moldboard mounting surface must be clean of all foreign material prior to installing new blades and hardware to avoid issues with bolt loosening while in service.

- ◆ For torque recommendation, please refer to SAE J1701
- ◆ Re-torque hardware after the first 10 plow hours

### Step 1

Clear moldboard of all foreign material before mounting, then install the Valkyrie Adapter Blade to the moldboard with 2" or 2.5" Plow Bolts included (varies with your set-up).

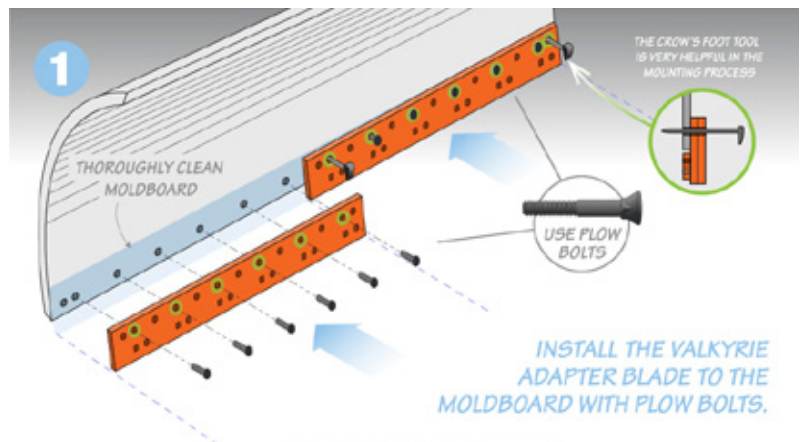

### Step 2

Insert Wedge Bolts through back of Adapter Blade & through the Valkyrie Perforated Blade. Slide Wedge Pin through Wedge Bolt to hold Valkyrie Blade in place.

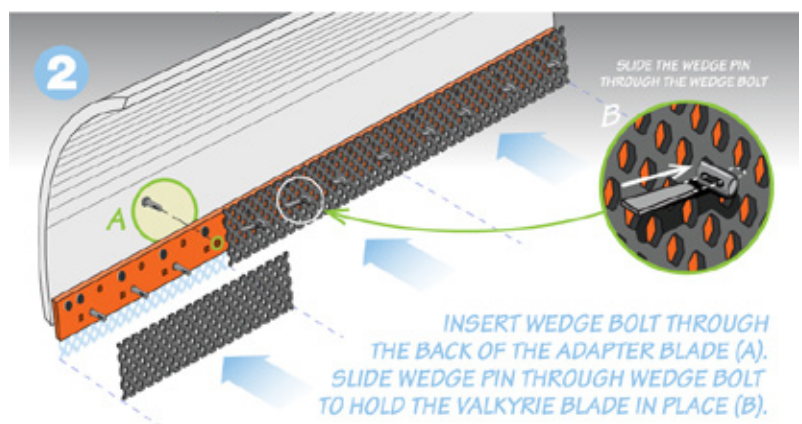

### Step 3

Secure a tight fit by firmly hammering the Wedge Pins into the Wedge Bolts. Check Wedge Pin tightness regularly during operation.

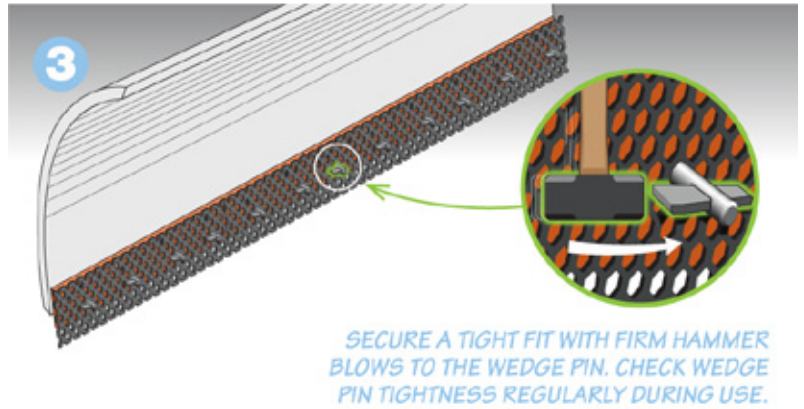

Check Wedge Pin tightness regularly during operation