

WINTER[®] Equipment's Snowplow Blade Measuring Guide Form

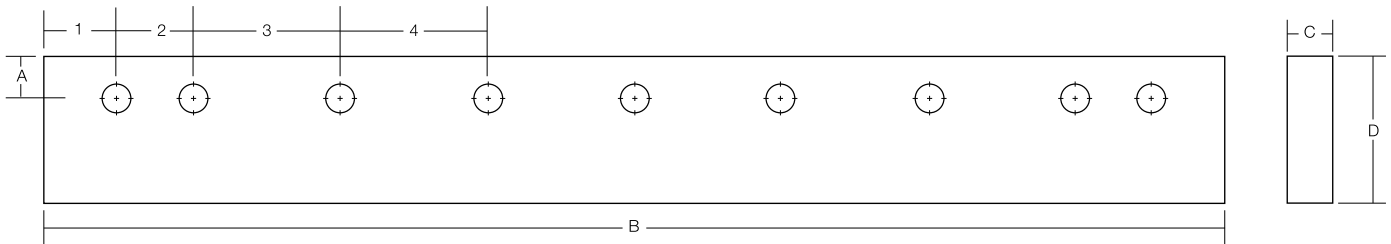

Send a separate order form for each blade size, if ordering multiple-size blades.

BLADE SPECIFICATIONS

A - Gauge Size 1" 1-1/2" 2" 4" *center punch*
(Distance from top of blade to hole center)

B - Blade Length (in feet)

C - Blade Thickness 3/8" 1/2" 5/8" 3/4" 1"

D - Blade Height 5" 6" 7" 8" 10"

Plow Manufacturer & Part Number (optional)

PUNCH PATTERN

1 - End of Blade to Hole Center (in inches)

2 - Hole Center to Hole Center (in inches)

3 - Hole Center to Hole Center (in inches)

4 - Hole Center to Hole Center (in inches)

HOLE TYPE

Blade Type	Carbide w/cover	Carbide w/o cover	Punched (Carriage Bolt)	Countersunk(Plow Bolt)
	Steel	Rubber		
Trip	Full	Bottom	Sectioned	

BILL TO

Company

Full Name

Email

Phone

Department

Address

City

State

PO#

ZIP

SHIP TO

same as bill to

Company

Full Name

Phone

Department

Address

City

State

PO#

ZIP



1900 Joseph Lloyd Parkway
Willoughby, Ohio 44094
Sales@WinterEquipment.com

Our quality impacts and protects what matters most, people! Call us today.

800.294.6837 | WinterEquipment.com