

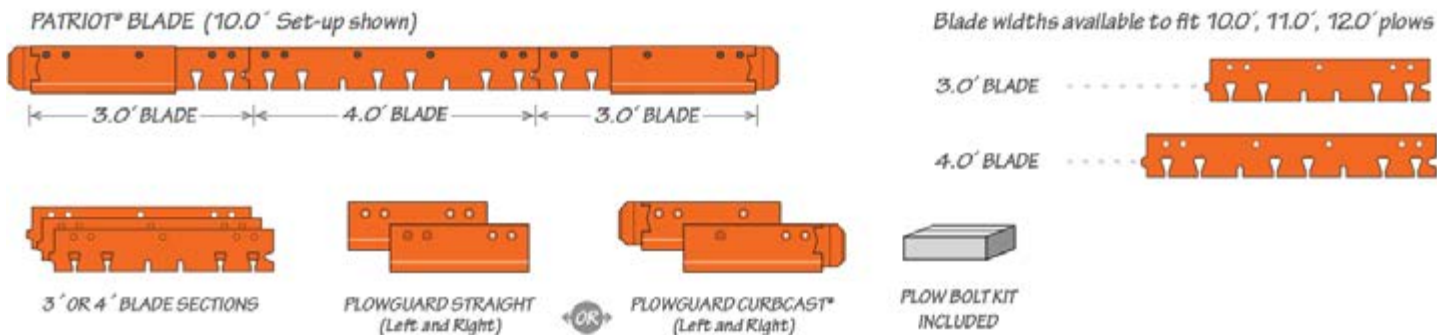

## INSTALLATION INSTRUCTIONS

# Patriot® Cutting Edge System

### PARTS INCLUDED



### IMPORTANT!

The moldboard mounting surface must be clean of all foreign material prior to installing new blades and hardware to avoid issues with bolt loosening while in service.

- ◆ For torque recommendation, please refer to SAE J1701
- ◆ Re-torque hardware after the first 10 plow hours

### Step 1

Install driver's-side main cutting edge with included shorter 3" Grade 8 plow bolts. Hand tighten. Do not install bolts in the three bolt holes on the end. These three holes will be used for plow guard installation.

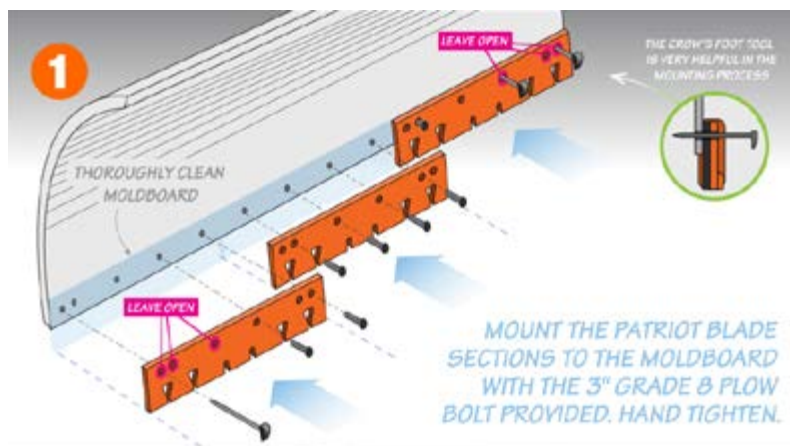

### Step 2

Install a plow guard on each end with included 3.5" Grade 8 plow bolts. Hand tighten.

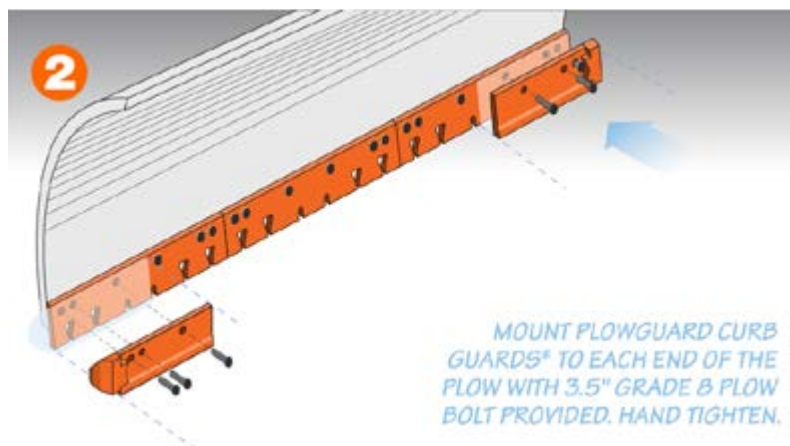

### Step 3

Set entire assembly on ground to ensure it's level.

Fully tighten all bolts. For torque specification, please refer to SAE J1701.



Re-torque hardware after the first 10 plow hours